

conference programme 2010

*11 October 2010
1.30pm - 5.15pm
Rangimarie Room 1
Telstra Clear Centre
Museum of New Zealand
Cable Street
Wellington*

*Thanks to our sponsors:
Hancocks Forest Management
Blakely Pacific Ltd
EECA Business
Timberlands Ltd
Rayonier / Matariki Forests
Natures Flame
Genera*

*and our ForestWood 2010 conference
partner New Zealand Trade &
Enterprise*



Informing and connecting our members and stakeholders

CONTENTS

Welcome	2
Sponsors	3
Speakers	4
Programme & venue	6

FOA are pleased to present a diverse range of international and national experts discussing their views and experience



Welcome

Thank you for being a part of the FOA 2010 conference.

A cross-section of topics will be covered by the conference programme including a Canadian perspective on future biopathways of the forest industry, genetic modification with an assessment of the risks and benefits to the forest industry, the government's work on second generation reforms to make New Zealand business friendly, an investors perspective on the forest growing sector and its investment potential for New Zealand and an insight into the role of Russia as a competitor to New Zealand logs and lumber by Gerry Van Leeuwen. An added advantage of this presentation by Gerry on Russia is his additional presentation at ForestWood 2010 tomorrow to give a related perspective on the China market.

A warm welcome to our speakers, especially those from overseas.

And a big thank you to our key sponsors for their ongoing support and commitment to the industry.

I encourage you to make the most of the occasion by engaging fully in what should be a very rewarding event and concentrated half day. I look forward to seeing you at the other pan-industry activities tomorrow which I am sure most of you will be attending.

David Rhodes | Chief Executive, FOA



*A Division of Hancock Timber Resource Group,
an MFC Global Investment Management Company*



sponsors

FOA would like to express their thanks to the following organisations for their generous support of this event. We encourage all delegates to recognise this consistent commitment.

- **Hancocks Forest Management**
- **Blakely Pacific Ltd**
- **EECA Business**
- **Timberlands Ltd**
- **Rayonier / Matariki Forests**
- **Natures Flame**
- **Genera**

With special thanks to our ForestWood 2010 conference partner



Rory Gilsean

Chief, Resource Economics and Bioenergy, Canadian Forest Service
Natural Resources Canada



Rory is based in Ottawa and has been with the CFS since 2003, working primar-

ily on bioenergy and climate change issues. His current work includes the development of a government decision-making framework for moving bioenergy technologies through to market maturity. An economist since 1991, he's a graduate of the University of British Columbia in Canada. Prior to joining the CFS, he worked as an economist for ten years with The World Bank, where he worked on projects and programs in the Middle East and West Africa in a variety of sectors and portfolios.

Christian Walter PhD



Senior Scientist, Team Leader Future Forests, Scion

Christian is a senior scientist and Team Leader of the Future

Forests team at Scion. He holds a PhD in molecular biology and biochemistry from the University of Bielefeld, Germany. Over the last 17 years he has been working on the development of genetic engineering technology and

has published widely on this topic. More recently he is focussing on field testing of genetically modified conifers and in particular the assessment of environmental risk. Christian has also published on the social, political and environmental aspects of gene technologies and he has presented to various public and scientific audiences. His current work includes the development of a government decision-making framework for moving bioenergy technologies through to market maturity. An economist since 1991, he's a graduate of the University of British Columbia in Canada. Prior to joining the CFS, he worked as an economist for ten years with The World Bank, where he worked on projects and programs in the Middle East and West Africa in a variety of sectors and portfolios.

Hon Dr Nick Smith

Minister for the Environment



Nick was born and educated in North Canterbury and first stood for public office at the age of 18 for the

Rangiora District

Council while still at High School. Nick attended Canterbury University where he completed a Civil Engineering degree followed by a PhD in Landslides. Having joined the National Party as a teenager Nick has held governing positions through all levels of the organisation and has been involved in several

campaigns.

Nick entered parliament in 1990 and was the first National MP in Tasman since 1932, then following the MMP reforms in 1996, was elected the first Nelson National MP since 1954. He continues to hold the seat with a comfortable majority. A Minister in the previous National Government he has held the portfolios of Education, Corrections, Conservation, Assoc Minister of Immigration, Treaty Negotiations and Social Welfare.

Nick is deeply involved in his local Nelson community, and particularly enjoys constituent work. Nick is married to Linley, and is the proud father of Hazel and Logan, and stepfather of Samantha and Alexander.

Gerry Van Leeuwen

Vice President, International Wood Markets Grp



Gerry has more than ten years of senior managerial and operational experience with a major coastal B.C. forest

company. With 27 years experience in the B.C. coastal wood products industry, he has gained in-depth knowledge and experience in all aspects of the forestry and sawmill business. His business and managerial experience includes log and chip trading, sawmill management, mill efficiency improvement, global wood

speakers

product markets, new product development, grade and value recovery, margin enhancement, value-adding processes, and team building related to lumber manufacturing. He has also been directly responsible for the marketing and sales of all grades and qualities of lumber and remanufactured products into the Pacific Rim, Europe, and North America.

Gerry has also travelled extensively to visit many industrial manufacturers throughout North America that produce cut stock, doors, windows, mouldings and millwork products. As well, Gerry has made dozens of marketing trips to Japan and Europe to meet with key industry customers. Gerry has developed excellent strategic insight into key industry operating issues and can provide analysis and recommendations for operational and marketing elements for investment purposes, plant renovations/ upgrades, new construction, and the due diligence process.

Bill Liley

**Associate Principal, Poyry
Management Consulting (NZ) Ltd**



Bill is a graduate forester with 33 years' experience in the New Zealand and international forestry sectors. His initial

experience was with inventory and

mapping functions in lowland tropical hardwood forests. This proceeded to the supervision, management and planning of harvesting operations in both natural and planted forests in Papua New Guinea. Bill spent a period of four years with the New Zealand Logging Industry Research Association, in which his primary areas of investigation included cable logging, small wood harvesting and harvest planning. In 1987 he was appointed Director of the inaugural New Zealand Forest Engineering Institute, a 10-week mid-career course in harvest planning, and has directed the three courses held since. From an original concentration on operational planning, and then tactical planning, Bill moved to strategic planning for forest resources, and in particular a specialisation in forest estate modelling. He has led Pöyry's initiatives in using the forest estate model as the underpinning structure within forest valuations. Bill has had an active role in the development of forest valuation practice for planted forests, and is an inception member of the NZ Institute of Forestry Valuation Working Group. Pöyry's forest valuation team is continuing to refine its developments and capabilities. Current initiatives are designed to ensure that the valuation model fully integrates with an authoritative business plan for the forest resource, and adequately reflects various forms of risk. Bill has been involved in forest planning, modelling and valuation assignments in New Zealand, Australia, Fiji,

Papua New Guinea, Malaysia, Indonesia, the Solomon Islands, South Africa, Tanzania, Chile, China, India, Uruguay, Argentina, Brazil and Guatemala.

David Rhodes

**Chief Executive, Forest Owners
Association**



David Rhodes is the Chief Executive of the New Zealand Forest Owners Association. With an extensive back-

ground in public policy, David represents the Association's 250+ members and their associated forest interests with local and central government. David provides support and strategic direction in key areas such as transport, the natural environment, fire management, health and safety, research and biosecurity.

Previous industry experience has been as the NZ Head of Delegation to the UN Forum on Forests, national focal point for the Food and Agriculture Organisation and economic advisor to the Canadian Forest Service. He is a Fellow and past executive member of the NZ Institute of Forestry and serves as a member of the FOA Advisory Committee on Paper and Wood Products and the International Council of Forest & Paper Associations. Areas of forestry expertise include climate change, plantation economics, nutrient trading, certification and water quality. David holds a BSc and MSc specialising in Zoology and Economics.

Conference Information

Name Badges

Name badges should be worn at all times for entry into the sessions

Storage

Bags and coats can be stored at the rear of the meeting room during the conference. Items are left at your risk

Toilets

Please see the venue map for the location of toilets

Cell Phones and Pagers

Please be considerate to other conference delegates and speakers during sessions by turning cell phones and pagers off or by placing in silent mode

Taxis & Shuttles

A taxi stand is located outside Te Papa for Wellington Combined Taxis, 04 384 4444. For a shuttle van, please contact Wellington Co-Operative Shuttles on 04 387 8787

“Informing and connecting our members and stakeholders.”



programme

Monday, 11 October 2010 FOA Business Conference	
1.30pm - 2.15pm	Future BioPathways of the Forest Industry: A Canadian Perspective Rory Gilsonan Chief, Resource Economics and Bioenergy, Canadian Forest Service - Natural Resources Canada
2.15pm - 2.30pm	Questions
2.30pm - 3.00pm	Assessing the Risks and Benefits of GMO for the forest industry Christian Walter Senior Scientist, Team Leader Future Forests Scion
3.00pm - 3.15pm	Questions
3.15pm - 3.30pm	Afternoon Tea
3.30pm - 4.00pm	RMA – second generation reforms to make NZ business friendly, NES, ETS, Water Hon Dr Nick Smith Minister for the Environment
4.00pm - 4.30pm	Russia as a competitor to New Zealand logs and lumber – What's happening? Gerry Van Leeuwen Vice President, International Wood Markets Group
4.30pm - 4.40pm	Questions
4.40pm - 5.00pm	Investors perspective on forest growing sector and its investment potential for New Zealand Bill Liley Poyry Management Consulting (NZ) Limited
5.00pm - 5.05pm	Questions
5.05pm - 5.15pm	Conclusion / wrap up comments David Rhodes Chief Executive, Forest Owners Association

Rangimarie Room 1
Telstra Clear Centre
Level 3
Museum of New Zealand Te Papa Tongarewa
55 Cable Street, Wellington 6011

TELSTRACLEAR CENTRE

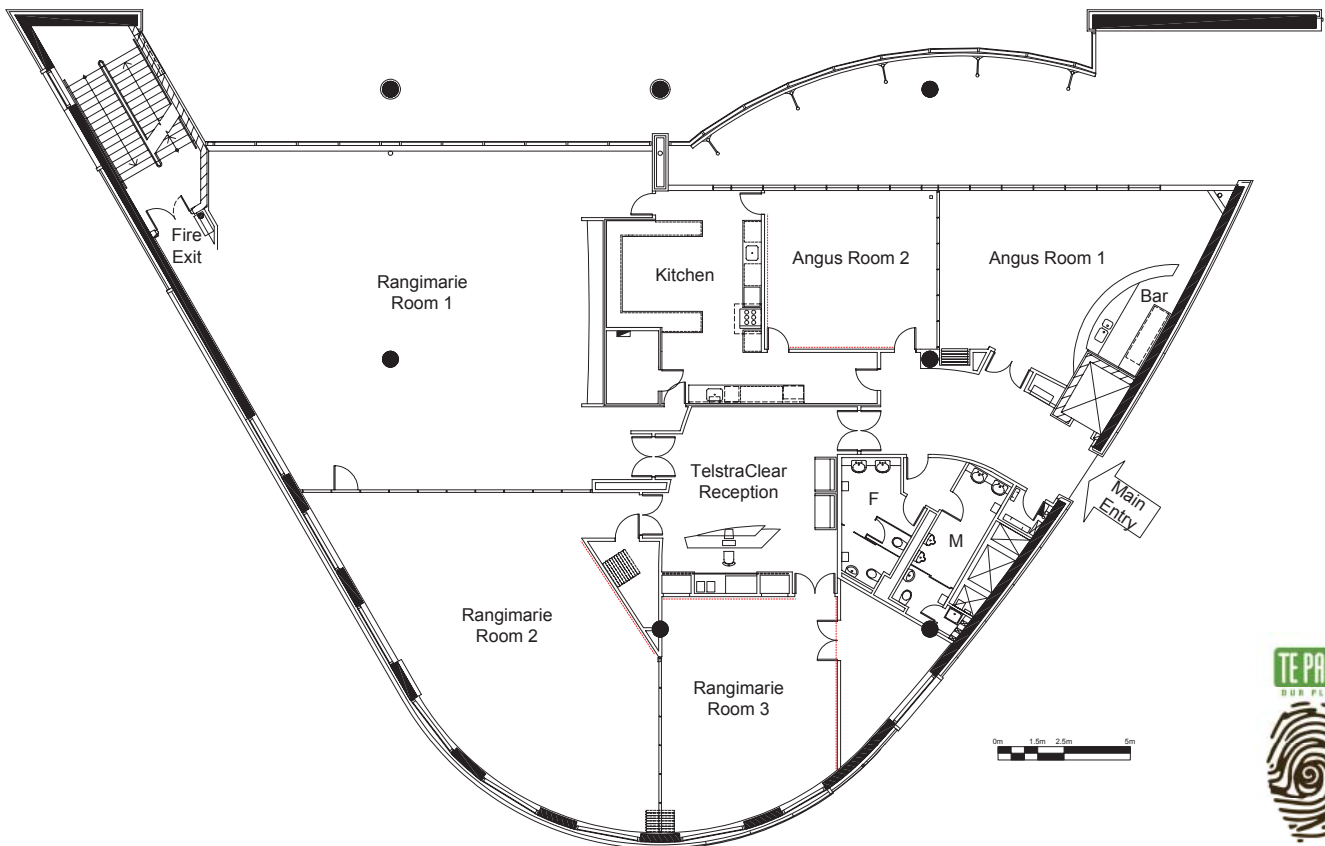

<http://www.nzfoa.org.nz>

